



MIKE ASHEY PRODUCTIONS
PRESENTS
VERY FIRE 1/350 SCALE USS MISSOURI, BB-63
TAPE UP REVIEW

There have been several in box reviews of this new 1/350 scale Missouri kit showing all the sprues, the instructions and the photoetch sheets. This “tape up” review of the kit allows you to see how all the main parts fit together and examine the surface detail and the fit issues. Some of the kit’s parts are very similar to Tamiya 1/350 scale Missouri parts and so this review also includes side by side pictures of some of the parts from the two kits. The parts count on this kit including the photoetch is approximately 1,100.

The fit of the hull halves is fairly tight except where the inner propeller skegs are located. The length of the hull seam is approximately 32.5 inches. The main deck is in three sections just like the Tamiya kit, however the forward deck section is approximately 1/16 inch too long. The main superstructure sides have nice surface detail such as hatches, portholes and piping, however they are separate parts. This means that you will have seams on the deck surfaces. There are superstructure sub-assemblies that have several sides to glue together and here again there will be seams that will need to be worked on.

The 16 inch turret assemblies are impressive and have nice surface detail. The 5 inch/38 turrets have separate sides and the seams will be difficult to remove without damaging the surface detail. The quad 40mm bases are one piece with a photoetch splinter shield, however the gun barrels seem to close together. The 20mm’s are above average and the photoetch shields fit tightly around each barrels base.

The plastic is somewhat soft and the yardarms and masts are easily bent so be careful during assembly and especially when you are adding rigging.

Most of the pictures are self explanatory and require no captions.

KIT NOTES

The hull halves fit together well and the seam is approximately 32.5 inches long. The seam between the inner propeller skegs will need some extra work. The hull seam should also be reinforced with laminations of plastic strip on the inside of the hull.

The bow seems narrow when compared with the Tamiya Missouri bow.

The bilge keels are nicely done and their is horizontal hull plating detail, but no water line.

The main deck is in three sections and the forward deck is approximately 1/16 inch too long. The deck planking is nicely done.

The deck planking between the seams on the aft deck section do not line up with the middle deck section planking.

Anchor chain is not molded onto the deck and the anchor holes on the hull are open. The anchors stems need to be made longer.

The main deck splinter shields are separate unlike the Tamiya kit which has deck inserts which include the splinter shield and a small section of the deck.

The photoetch is approximately .006 inches thick and the photoetch parts have nice surface detail.

The photoetch railing stanchions are thicker than the horizontal bars and they are an exact fit design.

The main deck photoetch railings are in 8 separate sections.

Intermediate scale modelers will be challenged when building the photoetch radars. Alternative photoetch radars by Gold Medal Models are recommended.

Photoetch catapults have the railings attached to the platforms for ease of assembly.

The 16 inch turrets have below deck detail and the turret surfaces have nice detail. The barrels will need to be bored out and they are separate from the blast bags.

The 5 inch/38 turrets have separate sides. After market resin replacements are recommended.

The 40mm guns appear to be to close together and care must be taken when removing them from their trees.

The 20mm guns are not bad and the photoetch splinter shields fit tightly around the base of the barrels.

The Mk-52 directors have two pieces one of which is very small.

There are binoculars for the stands—nice touch.

The aircraft are not clear plastic, however the canopies are tiny pieces of photoetch which have to be bent into shape.

The search lights have separate front and back parts.

The signal flag boxes have photoetch parts for the interior areas of each box.

Some locator pins have to be removed for a better fit.

Some parts like D-12 are not called out on the instruction sheet.

Be sure to wash all the parts as there is mold release agent on them.

The plastic is somewhat soft and the masts and yardarms can be easily bent. Replace the masts with stiff brass wire and reinforce the yardarms with brass wire.

The separate superstructure sides will create a lot of additional seam work which will be difficult to do without damaging the deck detail. Positioning the railings above the seams to hide them may be an acceptable solution.

There is a lot of mold line cleanup work to be done on some parts. There are also faint slide molding lines on many of the parts so check the surfaces carefully.

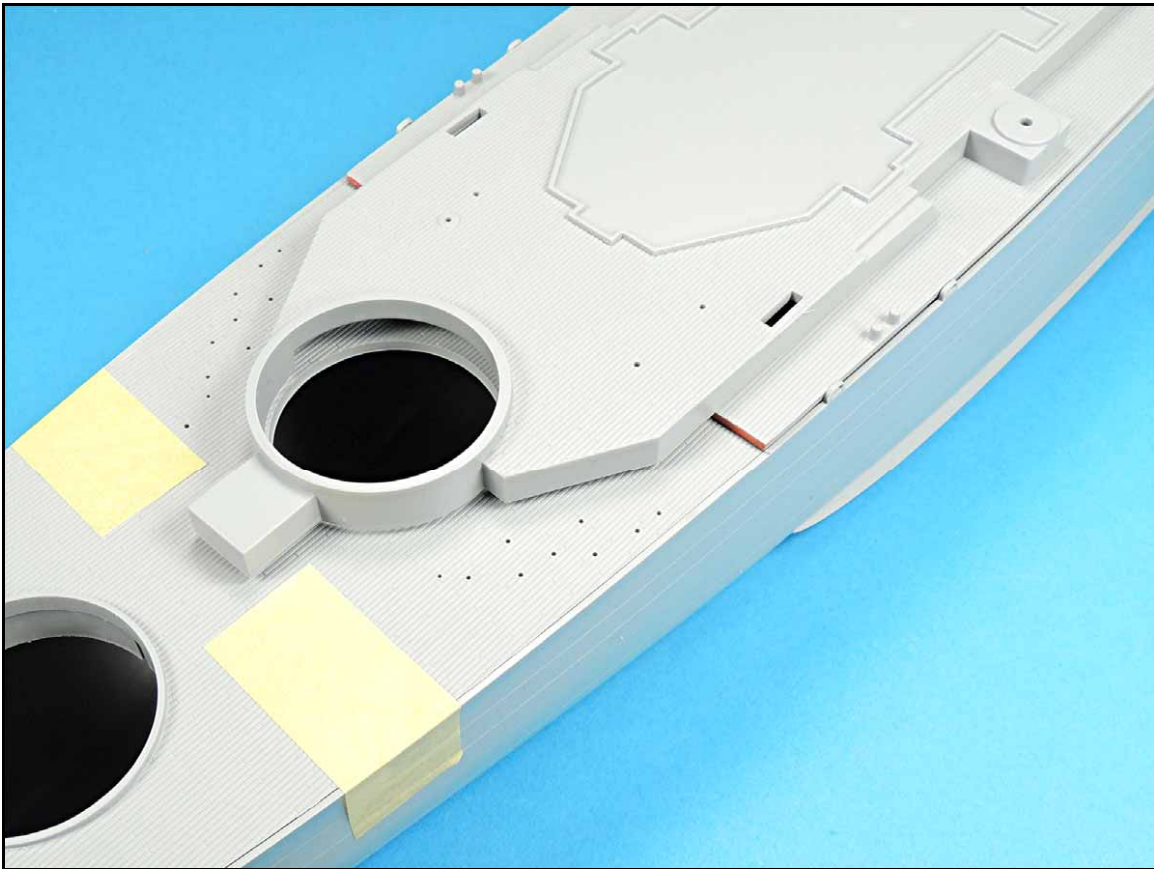

The forward deck section is too long.

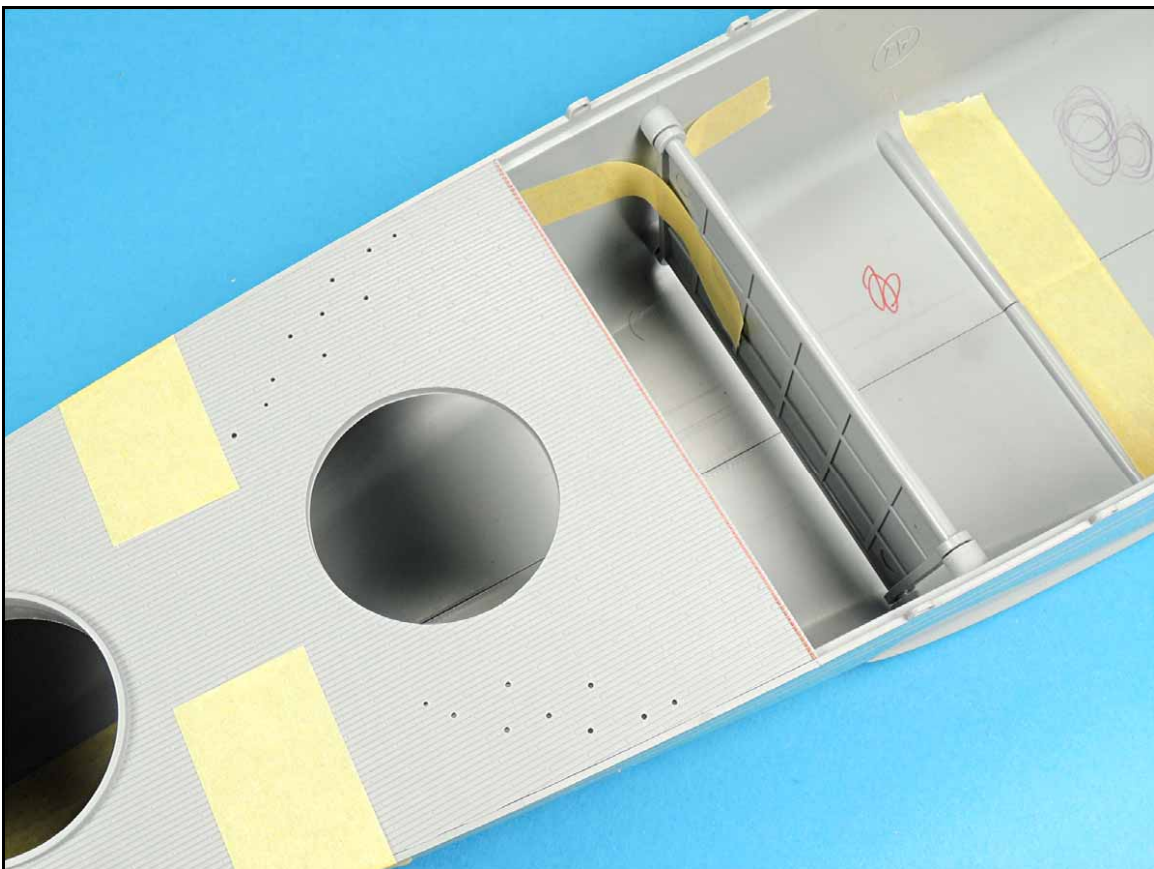

Approximately 1/16 inch needs to be removed for the deck sections to fit correctly.

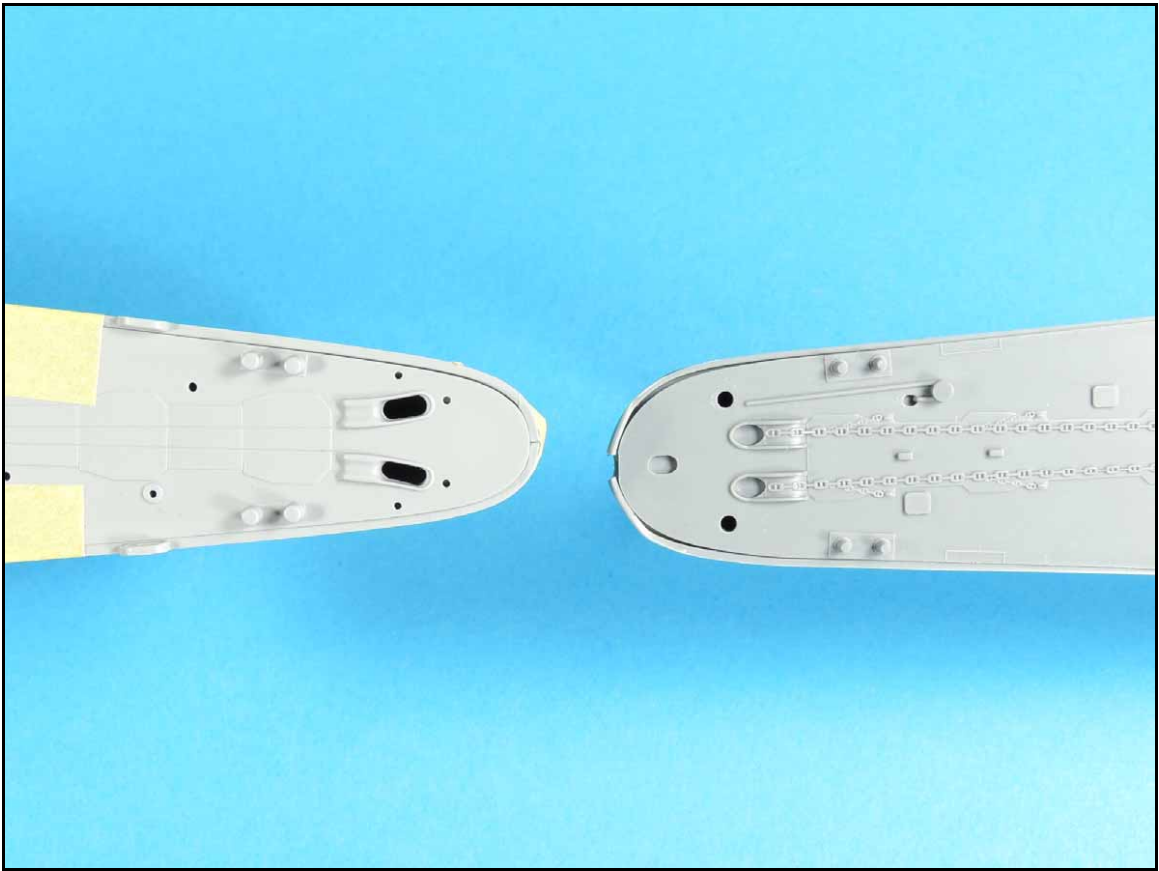

The Tamiya Missouri bow is on the right.



The seam line on the hull is approximately 32.5 inches long.

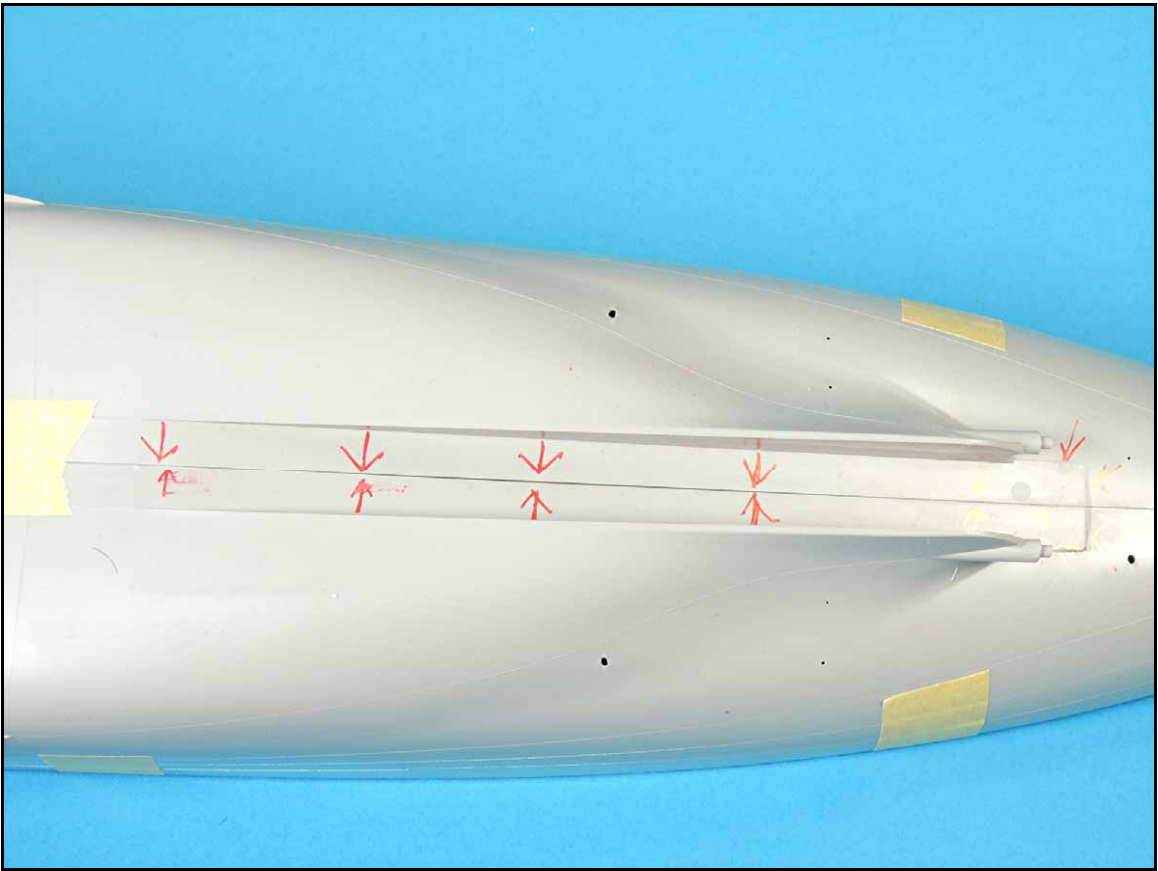

The area between the inner propeller skegs will need work.

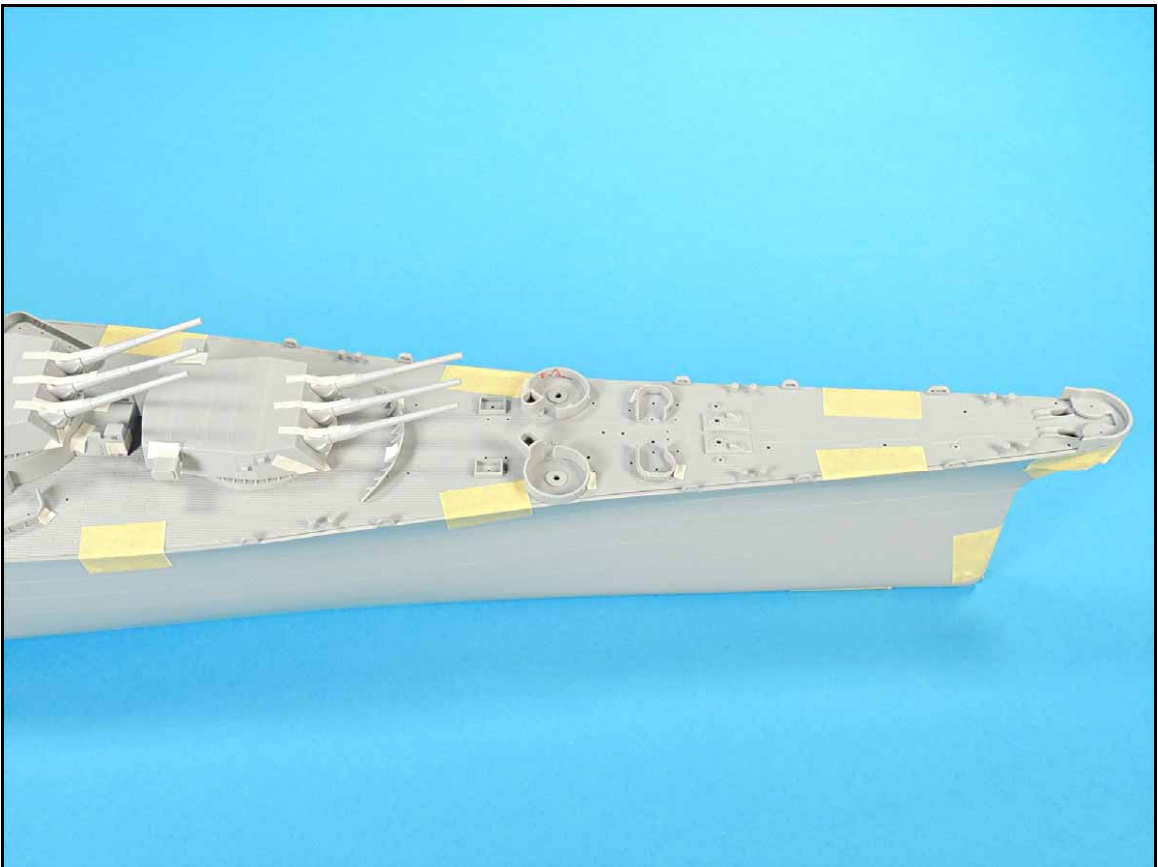

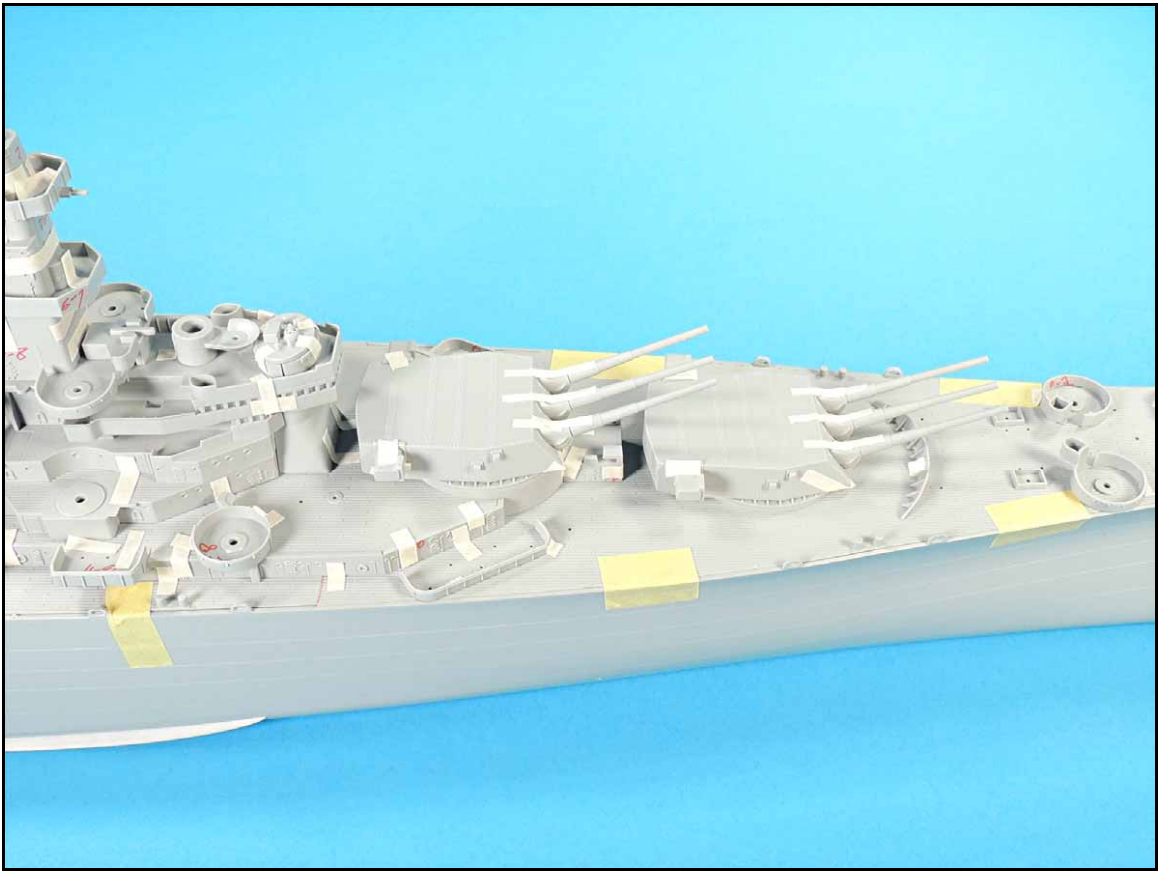





Anchor chain deck plating is nicely done.

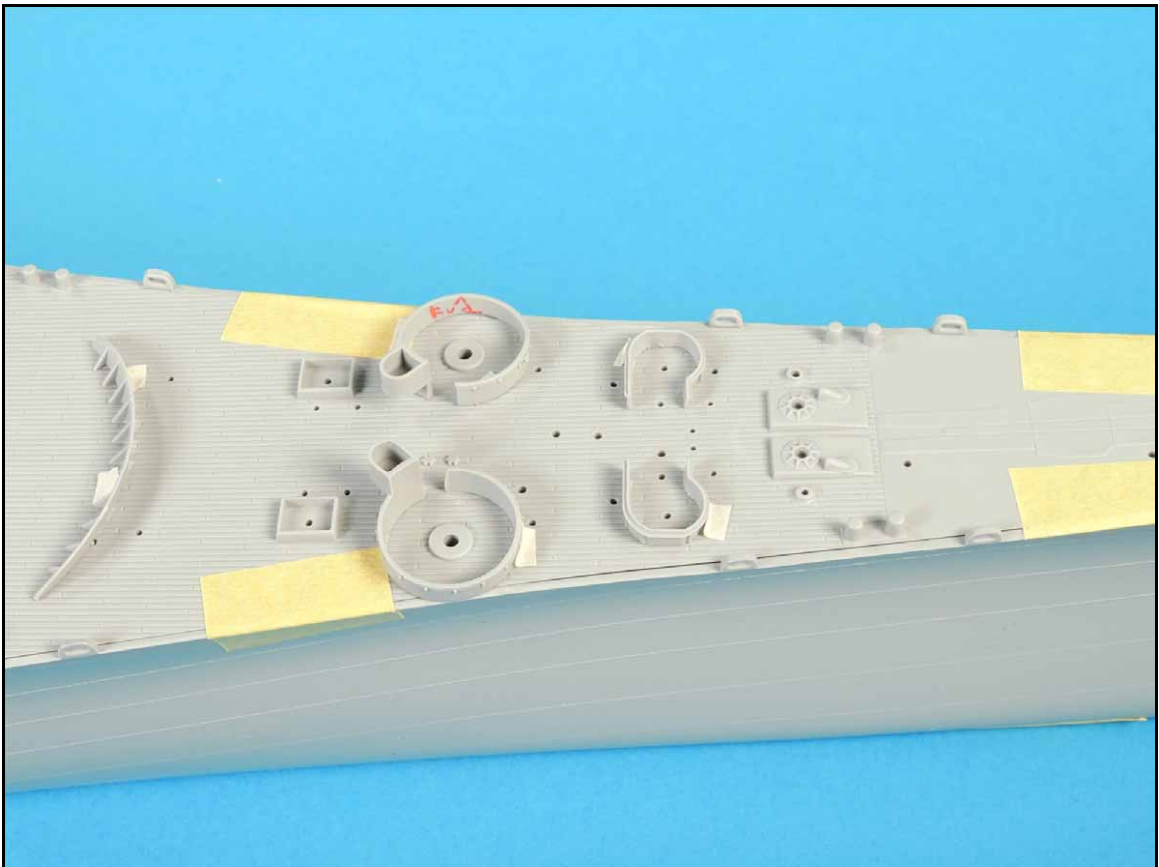

The deck splinter shields are not inserts like on the Tamiya kit. Both sides of each splinter shield will need tiny beads of super glue.



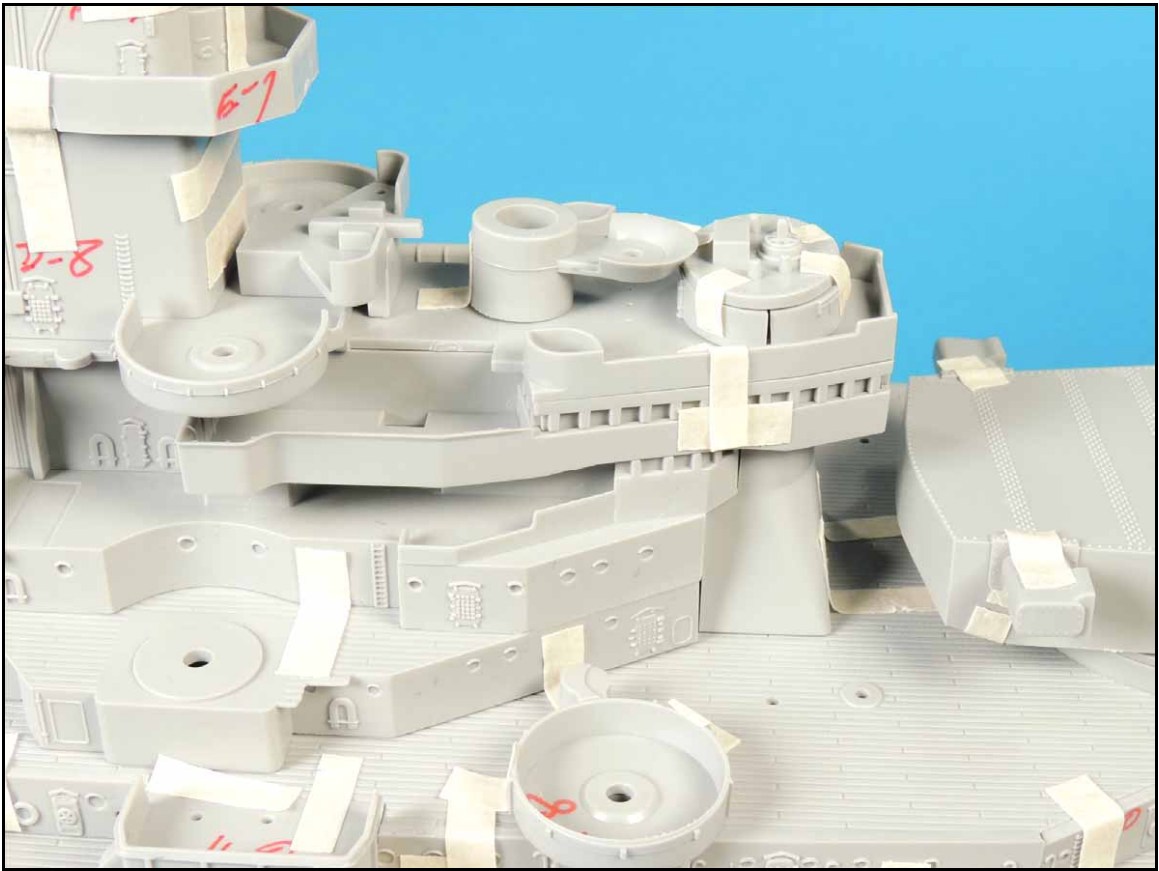

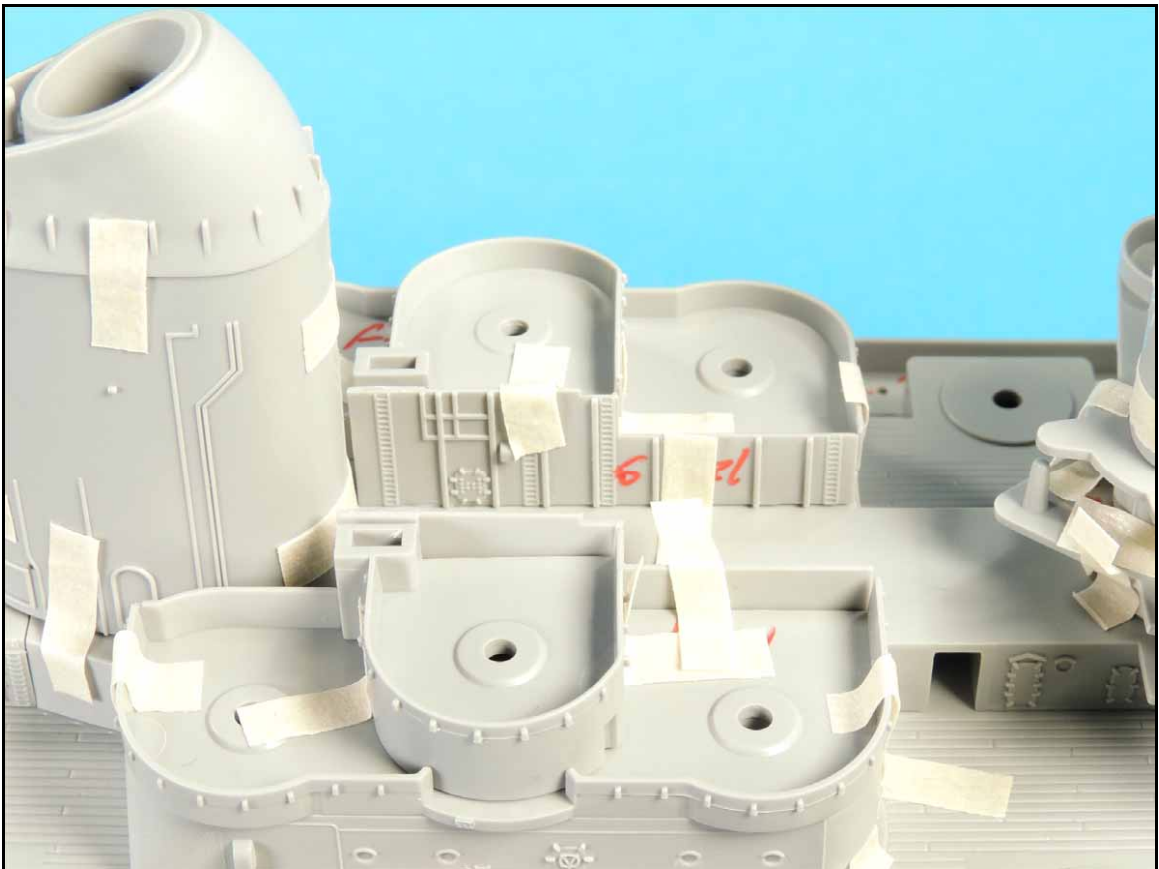



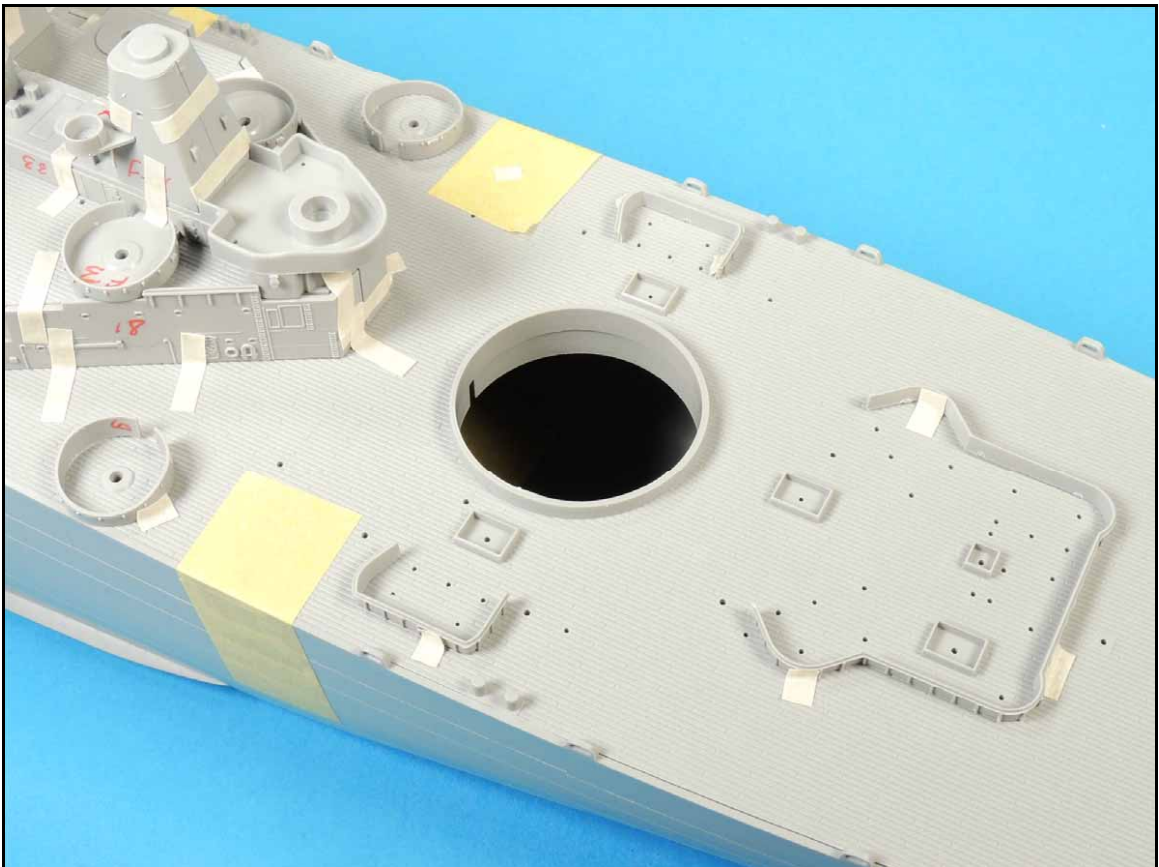

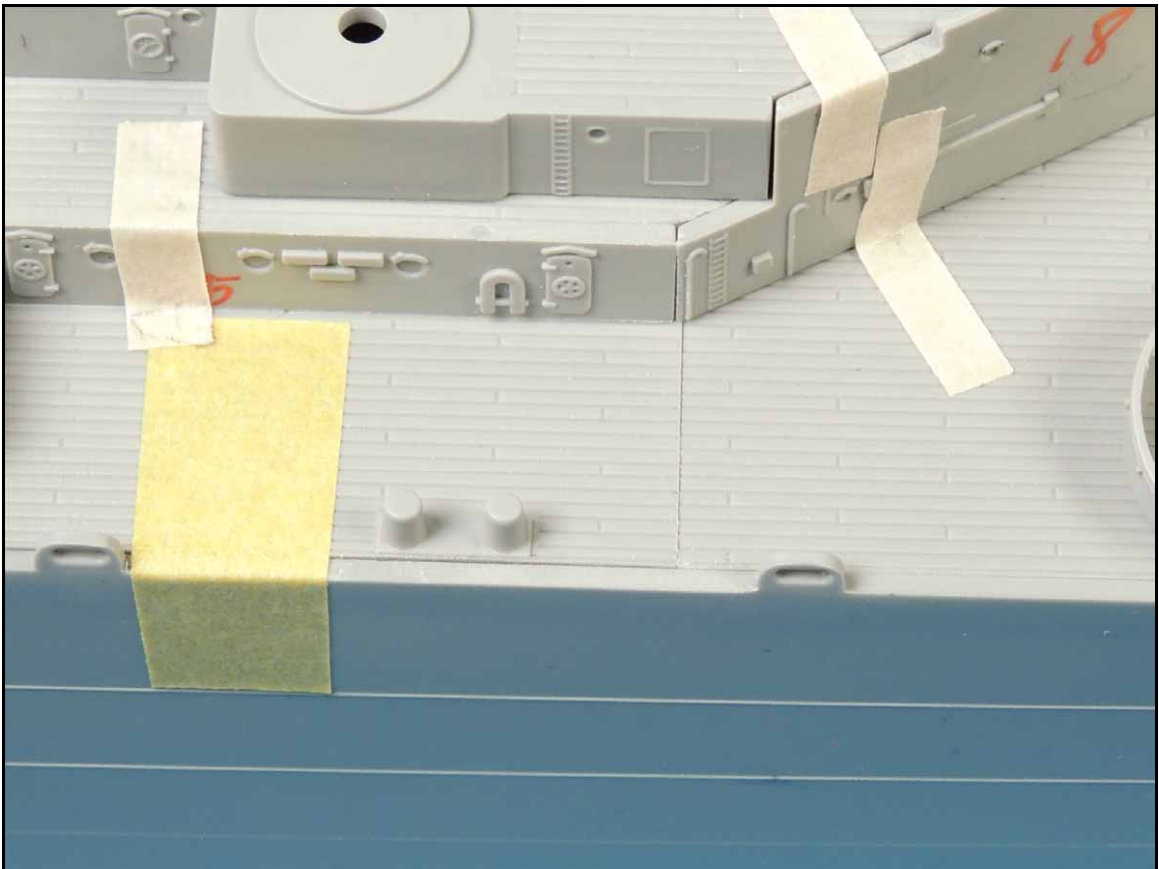
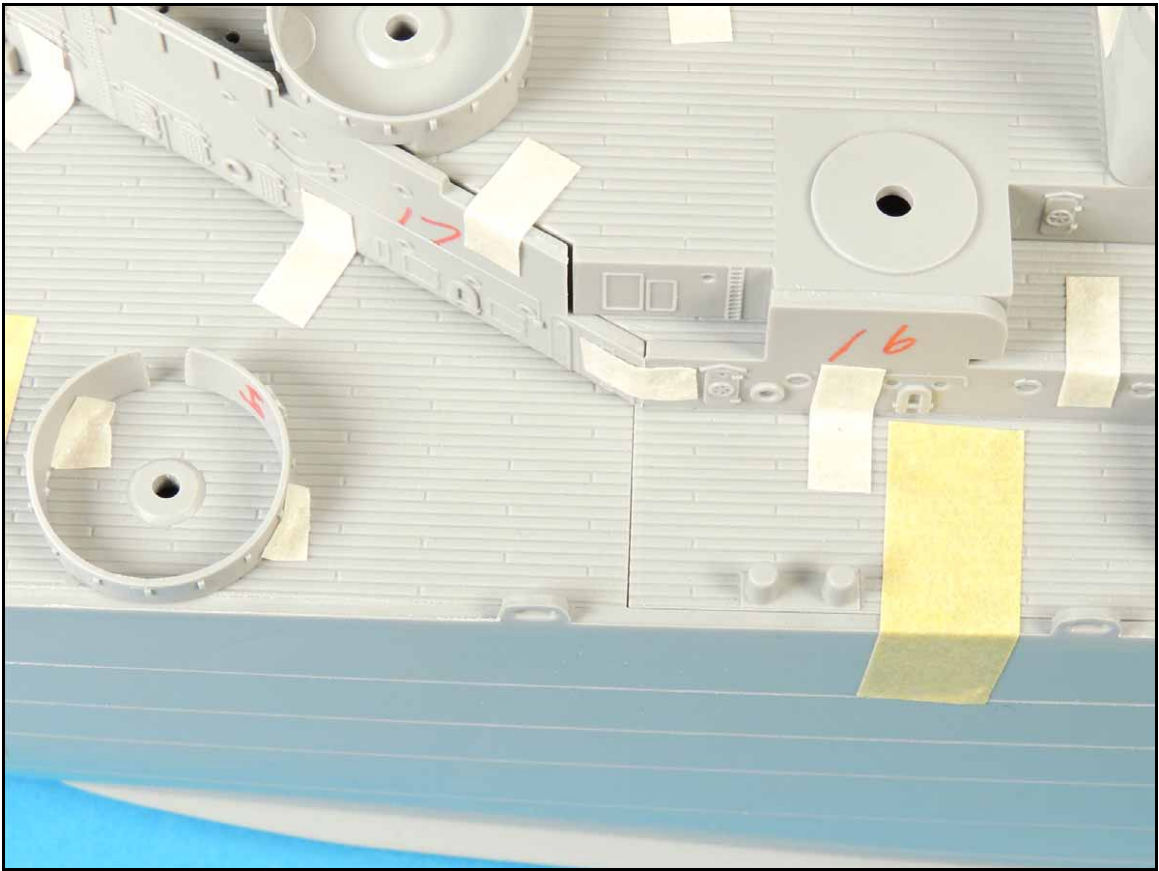

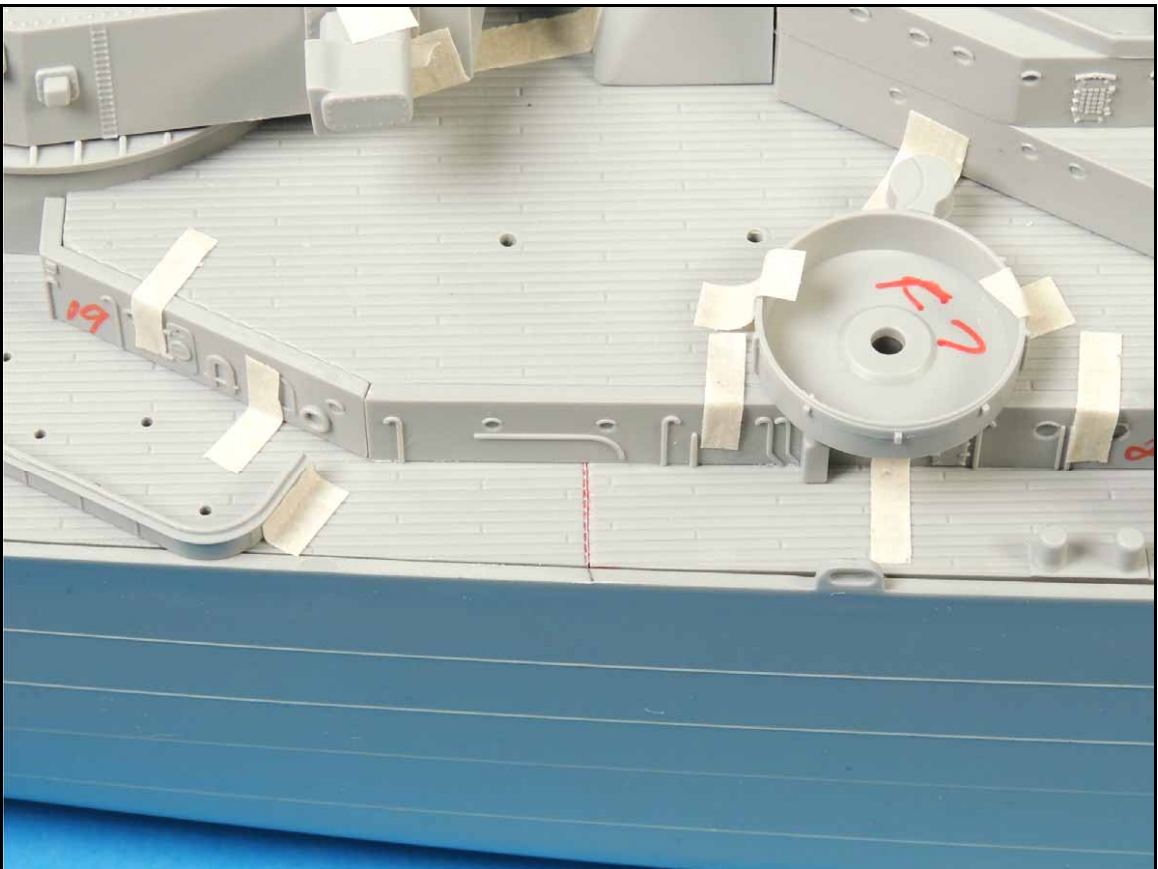
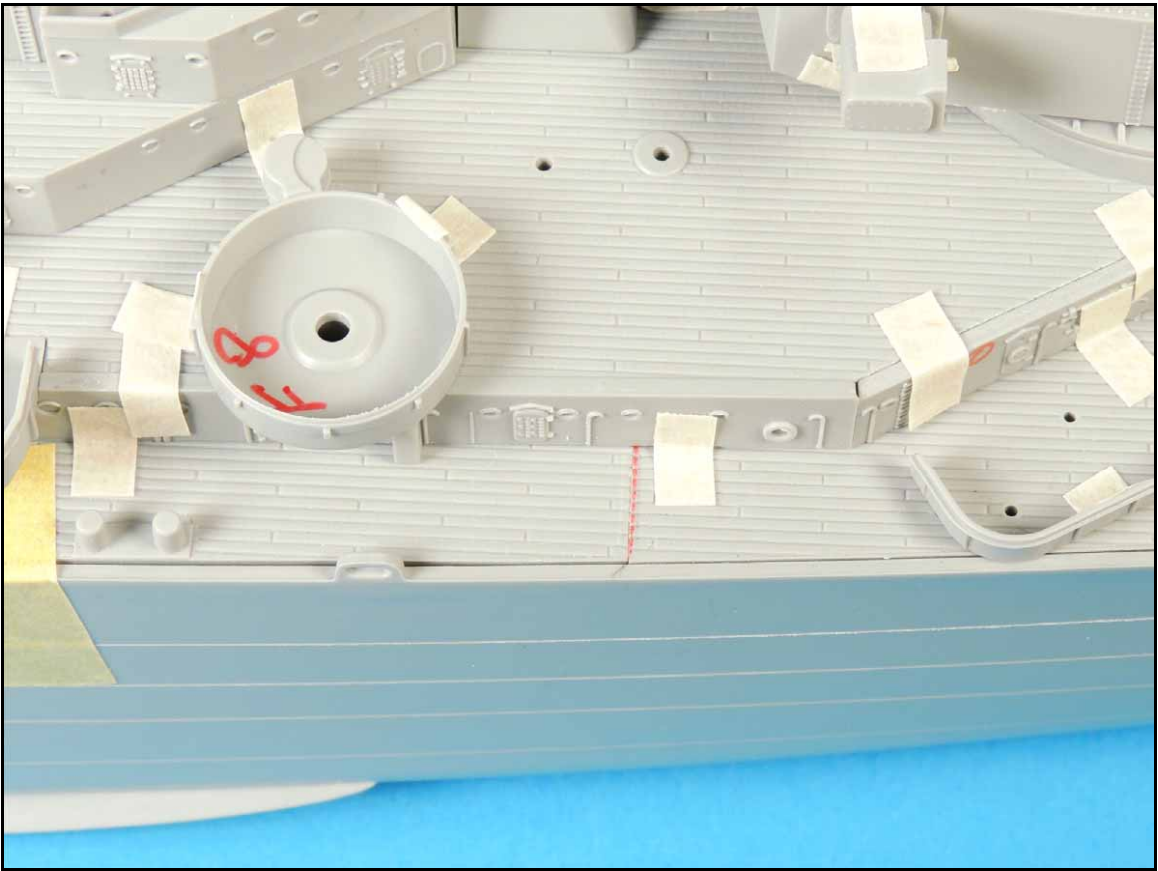

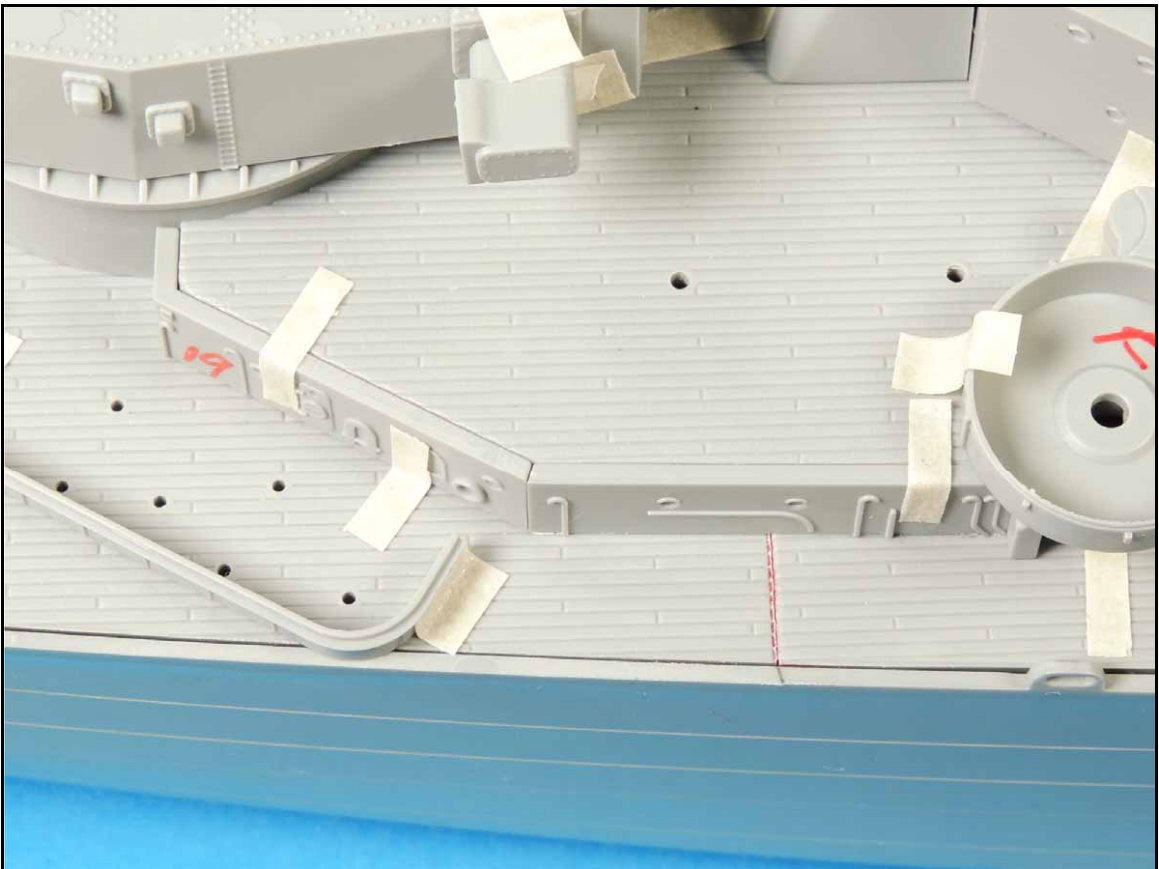
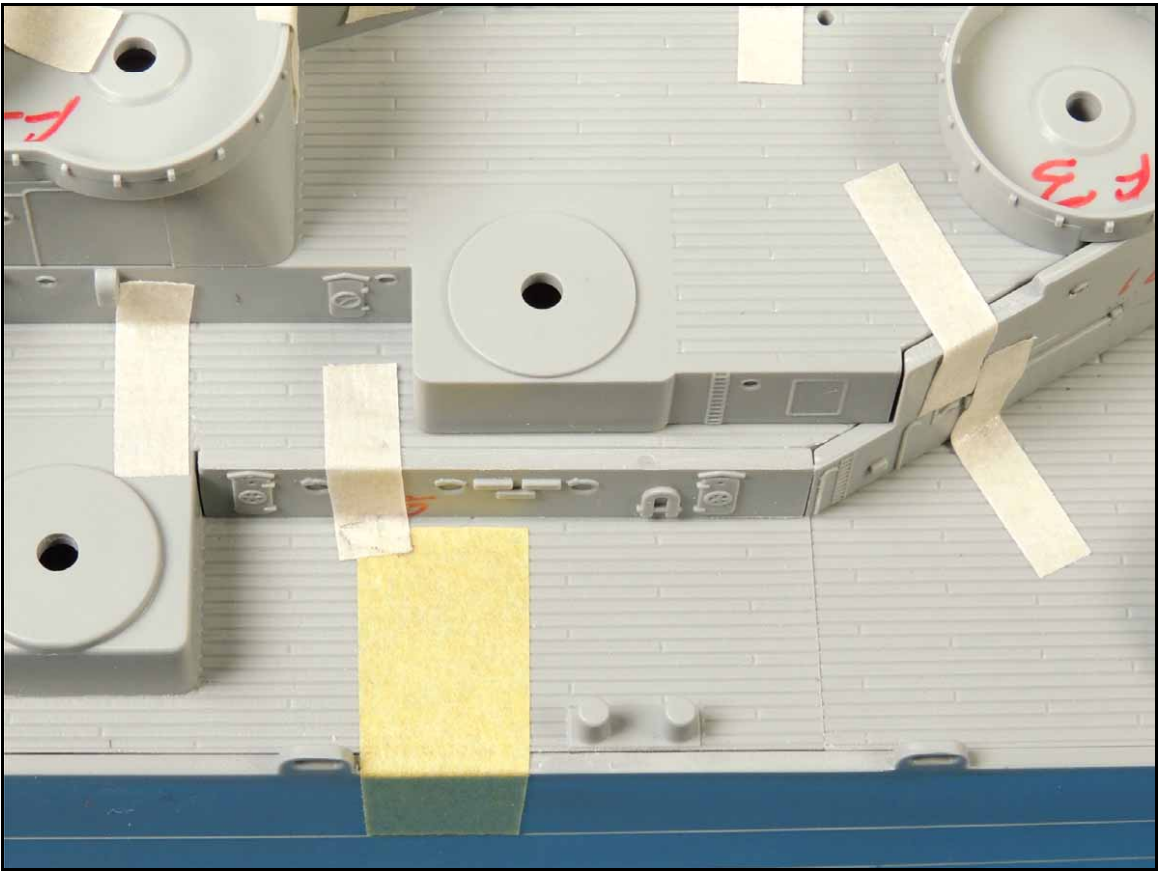

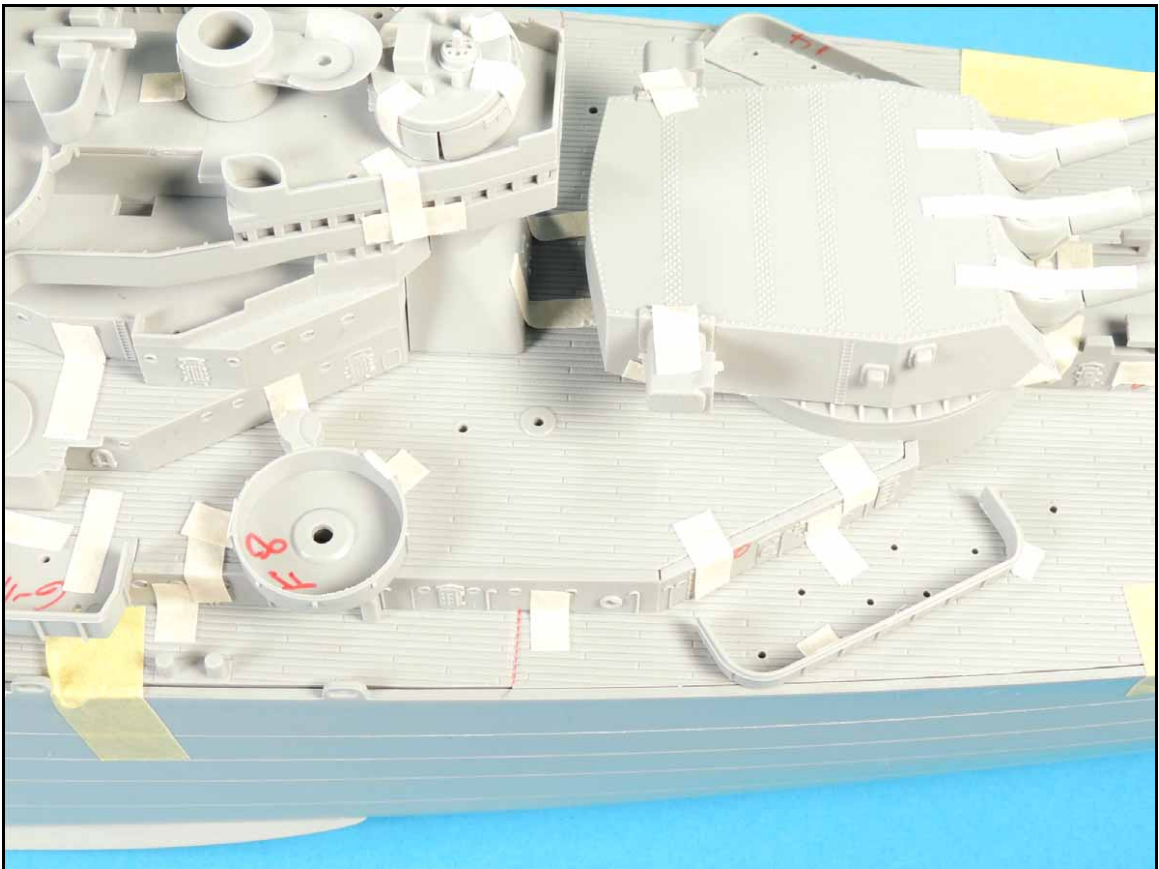
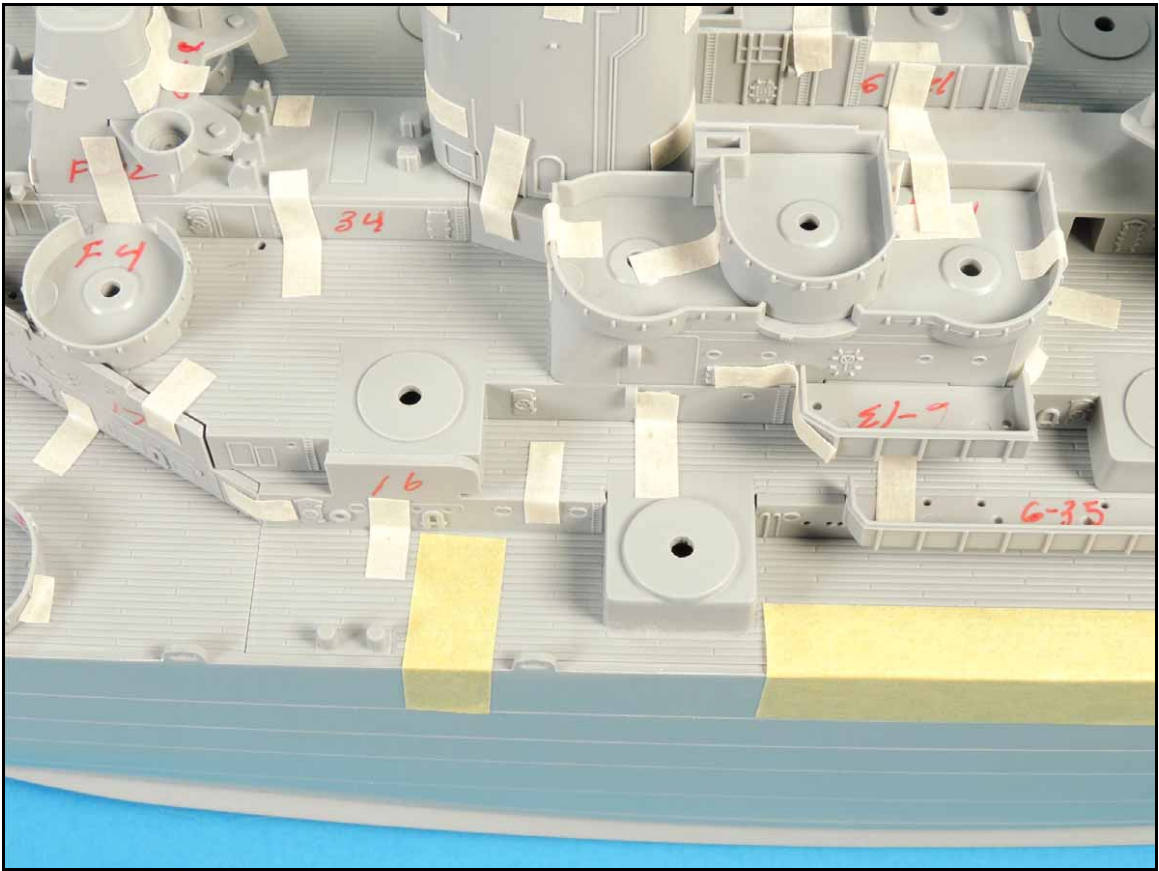

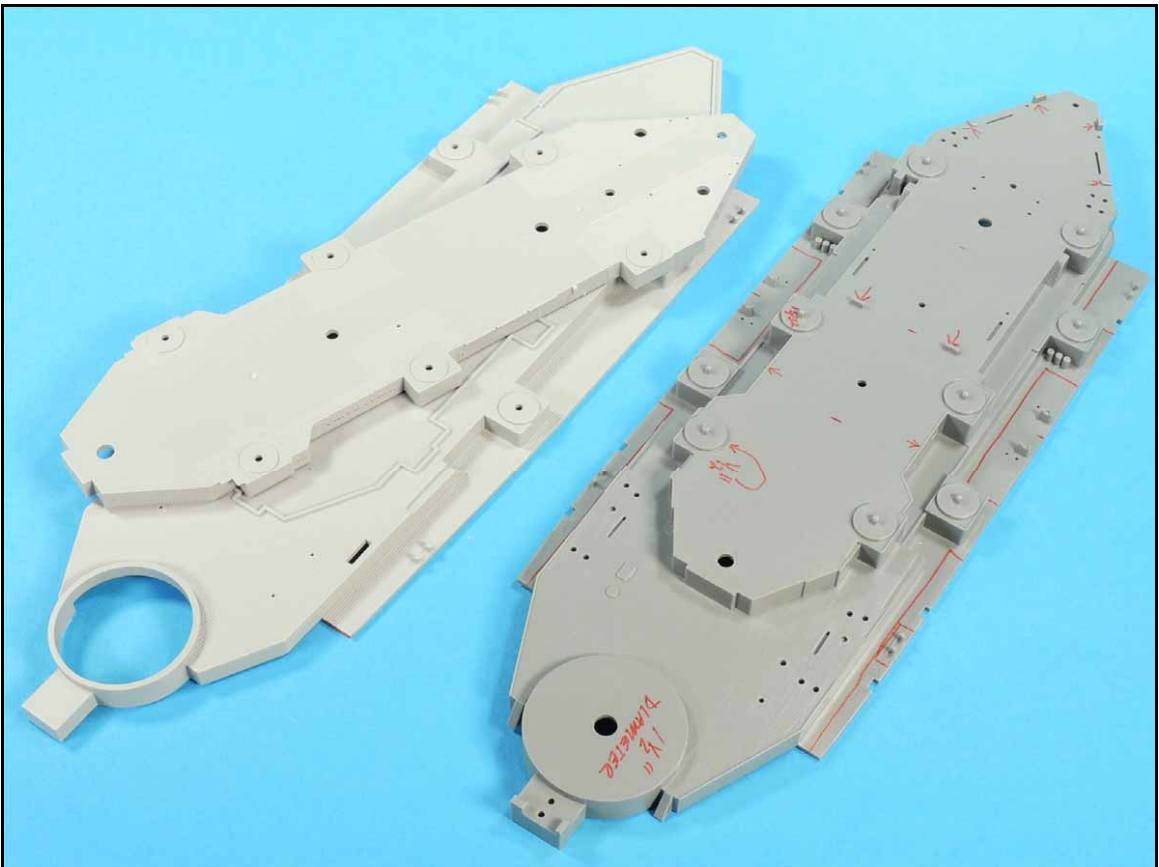
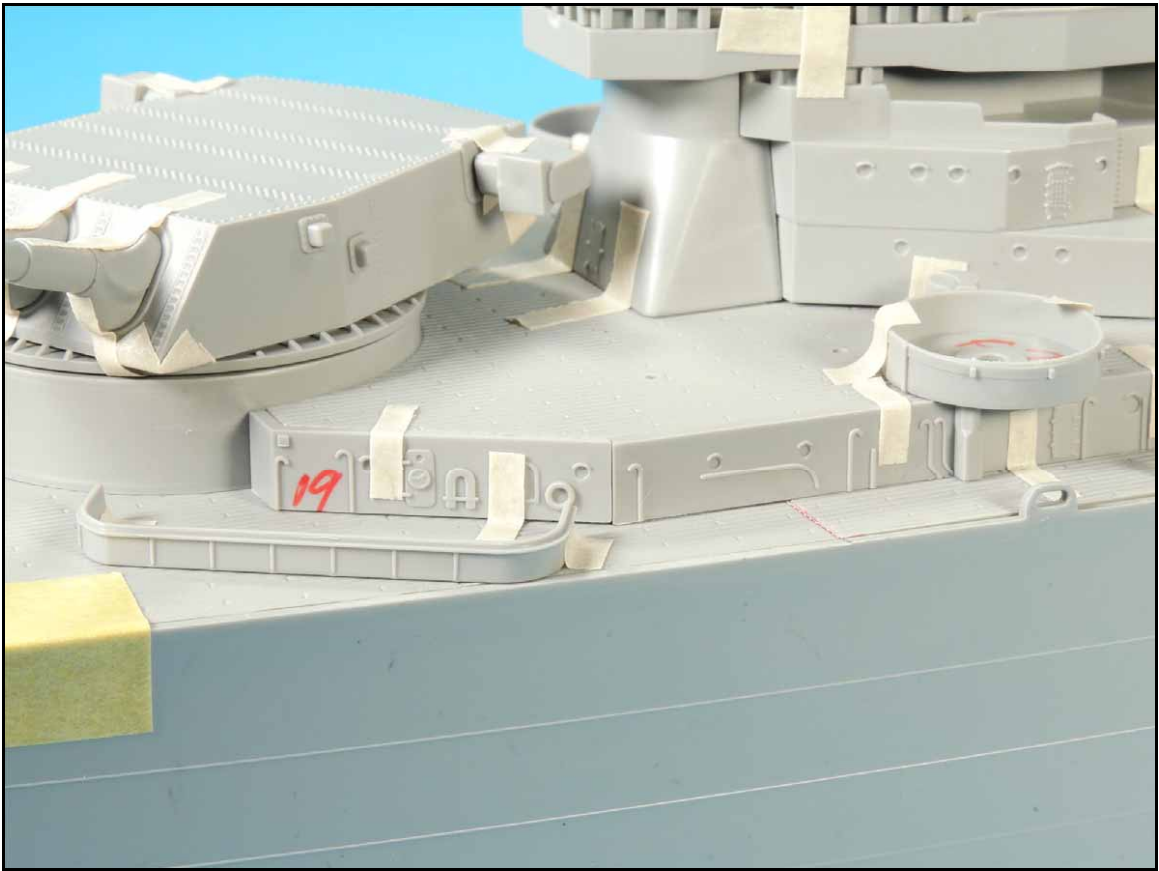

The remaining photos are comparisons between Very Fire parts (light gray) and Tamiya parts which are dark gray.

